



TS 72

Door Closer

The ideal solution for doors up to 1100 mm wide – tested and approved to EN 1154

The DORMA TS 72 is the ideal multi-purpose door closer for all standard door designs and constructions. Without a backplate, it is particularly easy and quick to fix.

The spring strength can be individually adapted to the door size by means of an adjusting screw.

Certified to ISO 9001

Benefits

For the trade

- Just one model for all standard doors.
- Increased stocking flexibility thanks to use of the standard ClassicLine series arm.

For the installer/fabricator

- Non-handed design.
- Closing force, closing speed and latching action adjustable in just a few movements.

For the architect/specifier

- Outstanding value for money.
- Compact construction combined with timeless design.

For the user

- Constant closing action virtually unaffected by temperature fluctuations.
- Optimum closing speed adjustment with two regulating valves.
- Reliable closing with adjustable latching action.

Data and features		TS 72
Spring strength adjustable	Size	EN 2 – 4
Standard doors	≤ 1100 mm ¹⁾	●
External doors, outward opening		–
Fire doors		●
Non-handed		●
Arm type	Standard	●
	Slide channel	–
Closing speed adjustable at 2 separate valves	180° – 15° 15° – 0°	●
Latching action adjustable (by arm)		●
Backcheck		●
Delayed action		–
Hold-open		○
Weight in kg		1.2
Dimensions in mm	Length Overall depth Height	232 45 68
Door closer tested and approved to EN 1154		●
CE mark for building products		●
Approved to AS1905 Part1 Fire Resistant Doors		●

● Yes – No ○ Option

¹⁾ With parallel-arm fixing, the closing force is approx. 20 Nm (for doors up to 950 mm)

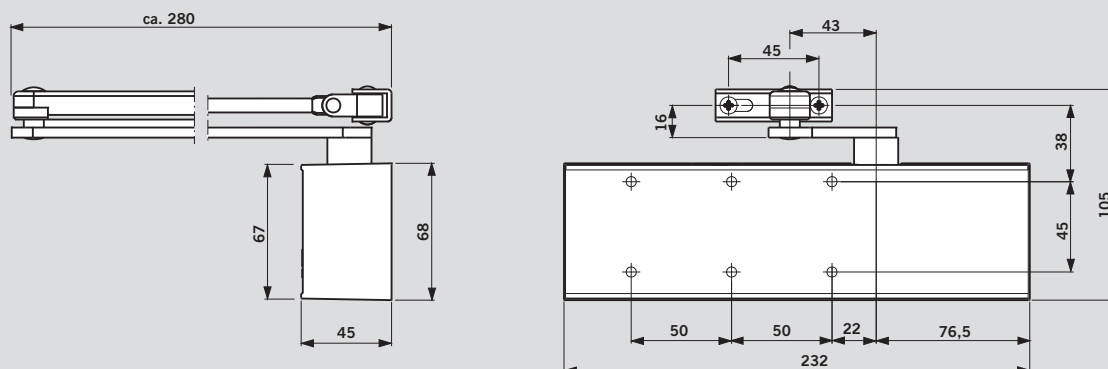

Door leaf fixing, pull side

(Example refers to left-hand [ISO 6] door; mirror image applies to right-hand [ISO 5] door)

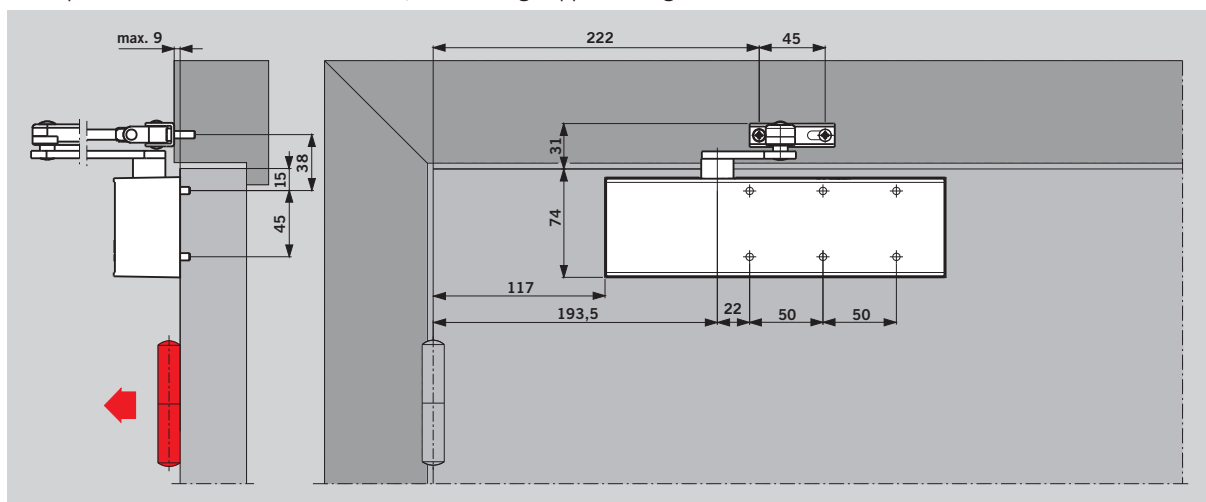

Transom fixing (overhead frame installation), push side

(Example refers to left-hand [ISO 6] door; mirror image applies to right-hand [ISO 5] door)

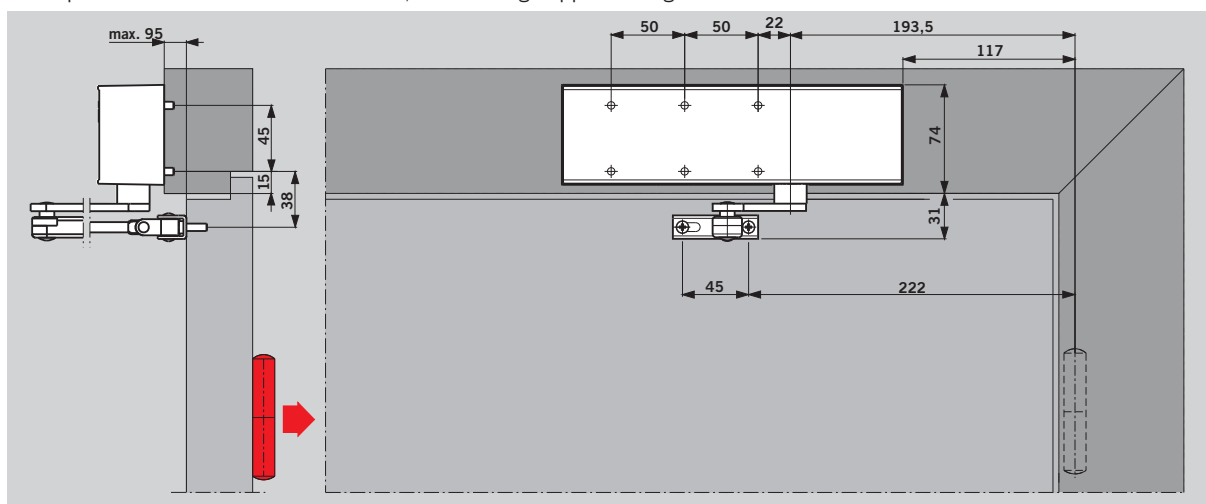

Parallel-arm fixing, push side

(Example refers to left-hand [ISO 6] door; mirror image applies to right-hand [ISO 5] door). Parallel-arm bracket (accessory) necessary

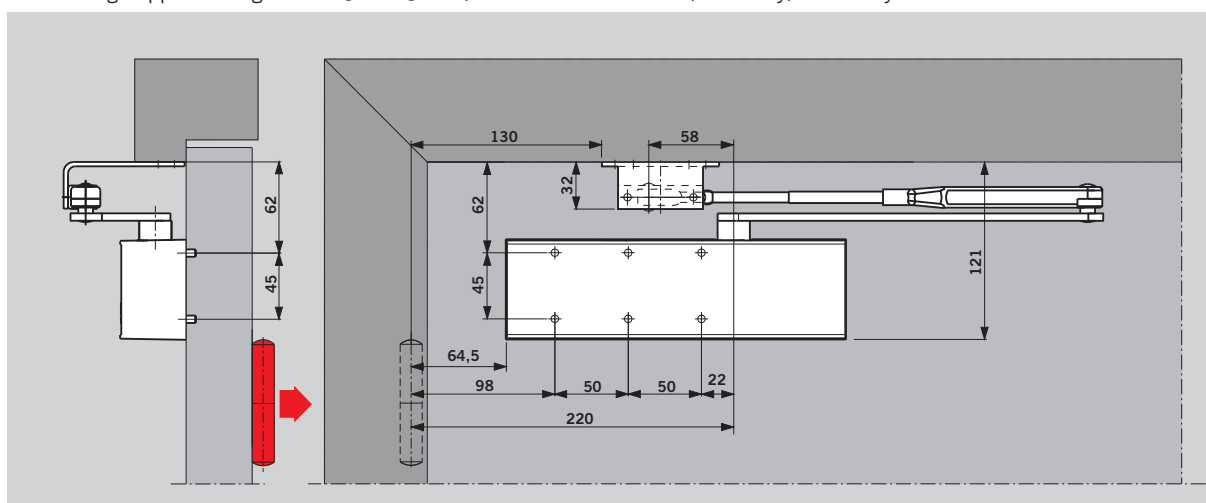

With this fixing method, the closing force is approx. 20 Nm (for doors up to 950 mm)

Mounting backplate

For fixing to doors on which the closer cannot be directly installed. Drilled hole pattern as per EN 1154, Supplement 1.

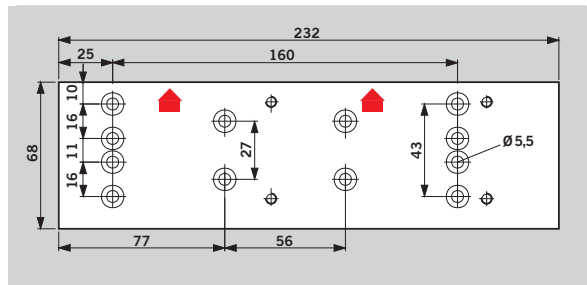
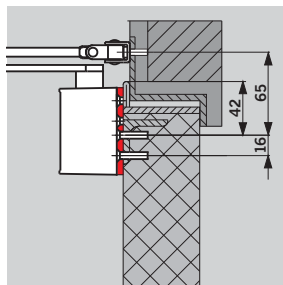

Upstand hinge bracket

For fixing the arm to particularly narrow door frames.

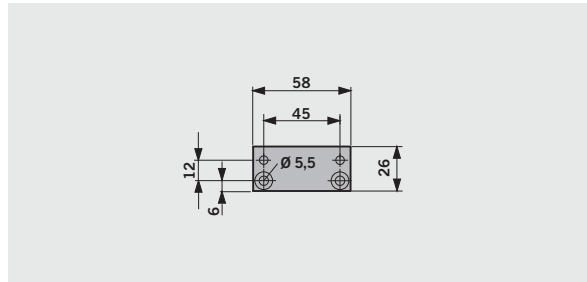
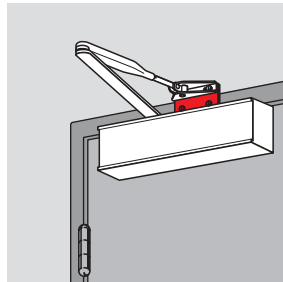

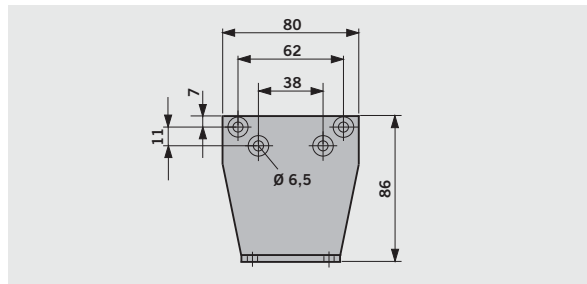
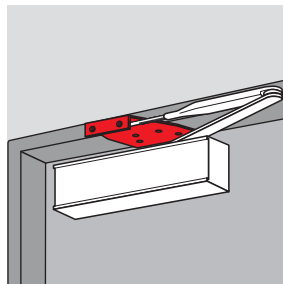

Fixing bracket

For the parallel-arm configuration.

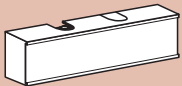
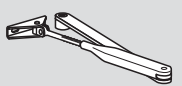
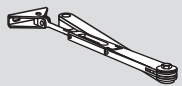
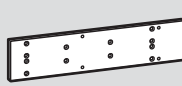

Standard equipment and accessories

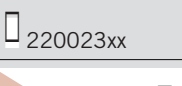
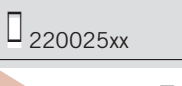
<p>Closer body TS 72</p> 	<p>Standard arm</p>  <p>220023xx</p>	<p>Hold-open arm</p>  <p>220025xx</p>	<p>Mounting backplate</p>  <p>220021xx</p>	<p>Hinge plate</p>  <p>830014xx</p>	<p>Parallel-arm bracket</p>  <p>280066xx</p>
<p>Size EN 2 – 4</p> <p>222521xx</p>			<p>#</p>	<p>#</p>	<p>#</p>

Order No.:

■ ■ = Closer separate

□ = Arm assembly separate

= Accessory

Colour

Silver

White (sim. to RAL 9016) 11

Special colour

XX

01

) 11

09

Specification text

Rack-and-pinion door closer with adjustable closing force, size EN 2 – 4, closing speed adjustable in two independent ranges, with adjustable latching action. Non-handed. Tested and approved to EN 1154.

Model

- ☐ with standard arm
- ☐ with hold-open arm

Accessories

- ☐ Mounting backplate
- ☐ Upright hinge plate
- ☐ Fixing bracket for parallel-arm assembly

Colour

☐ Silver
☐ Dark brown
☐ White (sim. to RAL 9010)
☐ White (sim. to RAL 9016)
☐ Special colour _____
 (sim. to RAL _____)

Make DORMA TS 72

Standard and optional functions

The **closing speed** of the DORMA TS 72 is variable in two independent ranges by separate valves.

In addition, the **latching action** can be adjusted at the closer arm.

The **closing force (size) setting** for the door width concerned is variable at the adjustment screw located at the end face of the TS 72 closer body.

Closing force settings

Door width	Setting
≤ 850	EN 2
≤ 950	EN 3
≤ 1100	EN 4

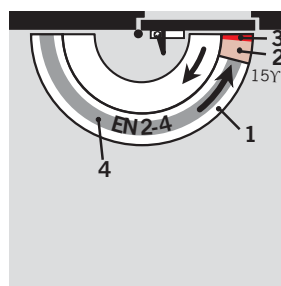
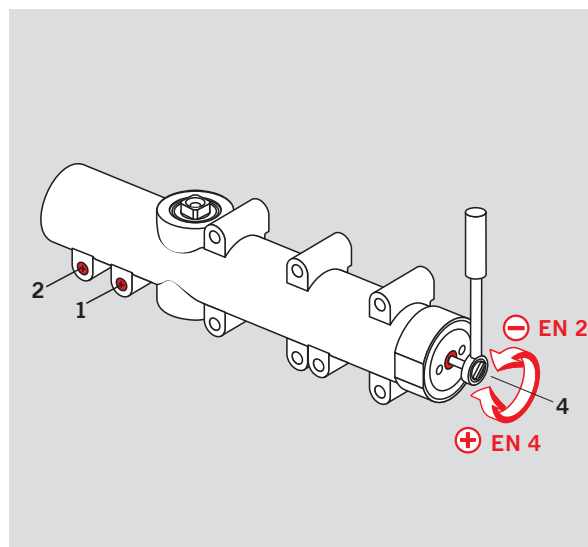

- 1 Closing speed adjustable in the range 180° – 15°.
- 2 Closing speed adjustable in the range 15° – 0°.
- 3 Latching action (variable at arm).
- 4 Adjustable closing force.

If the DORMA TS 72 is installed with a **hold-open arm**, the doors can be held open at any desired point (up to approx. 150°).

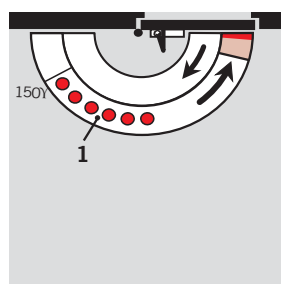

- 1 Hold-open range



Door Control



Automatic



**Glass fittings
and Accessories**



**Security Time
and Access (STA)**



Movable Walls

DORMA Door Controls P/L
Head Office
Victorian & Tasmanian
Sales Office
A.B.N. 82 005 869 447
52 Abbott Road,
Hallam, Victoria 3803
Telephone (03) 8795 0666
Facsimile (03) 8795 0280
Toll Free Facsimile
1800 333 309

New South Wales &
Australian Capital Territory
Telephone (02) 9645 8350
Facsimile (02) 9645 8355

Queensland
Telephone (07) 3394 6810
Facsimile (07) 3394 2953

South Australia &
Northern Territory
Telephone (08) 8337 4064
Facsimile (08) 8365 8572

Western Australia
Telephone (08) 9228 2322
Facsimile (08) 9228 2422

New Zealand
Dorma NZ Limited
Building P
61-69 Patiki Road
Avondale
Auckland 1026
Telephone (09) 830 2052
Facsimile (09) 820 4909